

# 5/F - 9/F FLOOR PLAN

## 5樓至9樓平面圖

- 開放式 Studio
- 一房 (開放式廚房) One Bedroom (Open Kitchen)
- 兩房 (開放式廚房) Two Bedrooms (Open Kitchen)
- 兩房 (獨立廚房) Two Bedrooms (Kitchen)
- 兩房 (獨立廚房) + 工作間 Two Bedrooms (Kitchen) + Utility Room
- 三房 Three Bedrooms
- 三房一套 + 儲物房 Three Bedrooms + Store Room

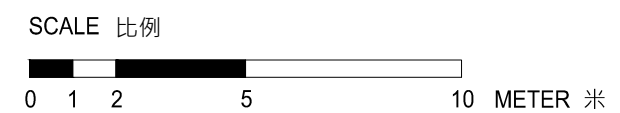
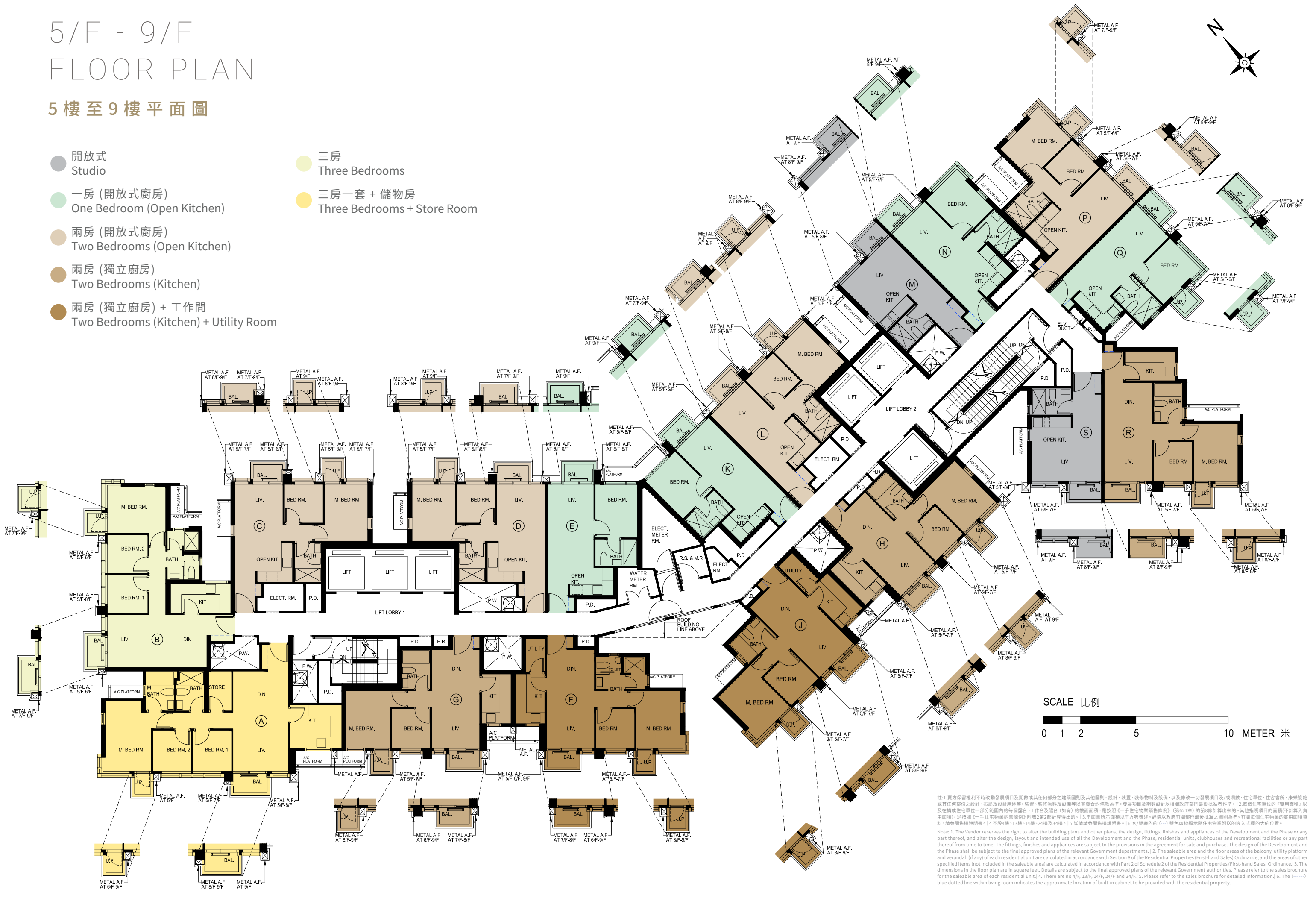

註: 1. 賣方保留權利不時改動發展項目及期數或其任何部分之建築圖則及其他圖則、設計、裝置、裝修物料及設備, 以及修改一切發展項目及/或期數、住宅單位、住宅會所、康樂設施或其任何部份之設計、布局及設計用途等。裝置、裝修物料及設備等以買賣合約條款為準。發展項目及期數設計以相關政府部門最後批准者為準。| 2. 每個住宅單位的「實用面積」以及在構成住宅單位一部分範圍內的每個露台、工作間及隔台 (如有) 的樓面面積, 是按照《一手住宅物業銷售條例》(第621章) 的第八條計算出來的。其他指明項目的面積 (不計入實用面積), 是按照《一手住宅物業銷售條例》附表2第2部計算出來的。| 3. 平面圖所示面積以平方米表示。詳情以政府有關部門最後批准之圖則為準。有關每個住宅物業的實用面積資料, 請參閱售樓說明書。| 4. 不設4樓、13樓、14樓、24樓及34樓。| 5. 詳情請參閱售樓說明書。| 6. 客/飯廳內的 (---) 藍色虛線顯示隨住宅物業附送的嵌入式櫥的大約位置。

Note: 1. The Vendor reserves the right to alter the building plans and other plans, the design, fittings, finishes and appliances of the Development and the Phase or any part thereof, and alter the design, layout and intended use of all the Development and the Phase, residential units, clubhouses and recreational facilities or any part thereof from time to time. The fittings, finishes and appliances are subject to the provisions in the agreement for sale and purchase. The design of the Development and the Phase shall be subject to the final approved plans of the relevant Government departments. | 2. The saleable area and the floor areas of the balcony, utility platform and verandah (if any) of each residential unit are calculated in accordance with Section 8 of the Residential Properties (First-hand Sales) Ordinance, and the areas of other specified items (not included in the saleable area) are calculated in accordance with Part 2 of Schedule 2 of the Residential Properties (First-hand Sales) Ordinance. | 3. The dimensions in the floor plan are in square feet. Details are subject to the final approved plans of the relevant Government authorities. Please refer to the sales brochure for the saleable area of each residential unit. | 4. There are no 4/F, 13/F, 14/F, 24/F and 34/F. | 5. Please refer to the sales brochure for detailed information. | 6. The (---) blue dotted line within living room indicates the approximate location of built-in cabinet to be provided with the residential property.